

E9 SERIES PHOTOCELL - LED LIGHTING COMPATIBLE

E9 Series offers cost and energy efficient solutions for variable lighting applications. E9 photocells are designed with an inverse OFF/ON ratio, thereby minimizing total operation hours. Extended time delay eliminates undesirable luminaire surge caused by lighting or other sudden changes in ambient light. AMI-E9-102-GR-IES has been specifically engineered to comply with I.E.S. recommendations.

Product Features:

- DC electromagnetic switch
- Non-drifting phototransistor
- Inverse OFF/ON ratio
- 20-40 second ON and OFF time delay
- Meets or Exceeds ANSI C136.10
- Design Life at Rated Load: 20,000 Cycles (20+ years)
- Complies with I.E.S. Recommendation
- Cost Effective & Energy Saving
- 10 Year Product Warranty
- UL/CSA Listed (CUL)
- RoHS Compliant

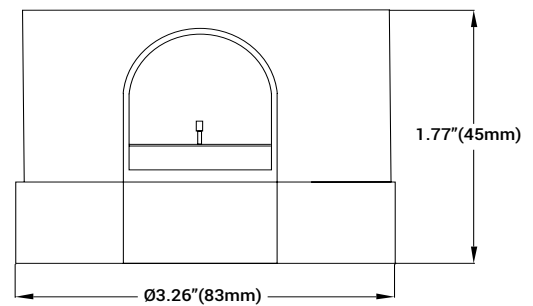

Specifications:

Physical

Enclosure: Designed to meet ANSI C136.10.
 Dimensions: Approx. 3.26" (83mm) dia x 2.08" (53mm) height
 Power Consumption: Less than 1.1 Watts (max.) at 120VAC

Temperature Range

-40°F to 158°F (-40°C to +70°C) at 96% RH

Light Sensor

Non-drifting phototransistor

Relay Rating

30 Amp rated general purpose relay

Load Rating

1000 Watt Tungsten, 1800 VA Ballast

Cover

High impact polypropylene with UV stabilized polycarbonate window

Base

High temperature polyester (PBT)

Connection

3-pole locking type with solid brass blades

Gasket

Cross-linked polyethylene

E9 Series Product Selection Information

XXX - Denotes Optional Customer Number

Model	AMI-E9-102-BL-XXX	AMI-E9-102-BL-IES-XXX	AMI-E9F-102-BL-IES-XXX
Rated Volts (VAC)	120/208/240/277	120/208/240/277	120/208/240/277
Voltage Range (Volts)	105-305	105-305	105-305
Turn ON (Fc)	1.5+/-0.5	3.0+/-0.5	1.5+/-0.5

E9 Series Technical Data

Voltage Range	Frequency	ON/OFF Ratio	Time Delay ON/OFF	Operating Light Levels	Fail Mode	Surge Protection
105-305 VAC	50/60Hz	0.6:1	20-40 Second ON and OFF delay	Standard 1.5 Fc or 3 Fc	E9: ON E9F: OFF	180J or 545J