

AMI Designation	Input/output Style		Current Rating	Inductance	Capacitance		Resistor	Leakage Current @ 120 VAC 60Hz/250 VAC 50 Hz	TIL Insertion Loss	Case Style
					Cx	Cy				
Available Part Numbers	0.250 Spade Terminals	Wire Leads		mH	nF	pF	K Ω	mA		
AMI-M11AA-1-1-B	1	-	1	10	47	3000	1500	0.25/0.5	001	A
AMI-M11AA-1-3-B	1	-	3	1.45	47	3000	1500	0.25/0.5	002	A
AMI-M11AA-1-6-B	1	-	6	0.465	47	3000	1500	0.25/0.5	003	A
AMI-M11AA-1-10-B	1	-	10	0.35	47	3000	1500	0.25/0.5	004	A
AMI-M11AA-4-1-B	-	4	1	10	47	3000	1500	0.25/0.5	001	B
AMI-M11AA-4-3-B	-	4	3	1.45	47	3000	1500	0.25/0.5	002	B
AMI-M11AA-4-6-B	-	4	6	0.465	47	3000	1500	0.25/0.5	003	B
AMI-M11AA-4-10-B-1	-	4	10	0.35	47	3000	1500	0.25/0.5	001	B
AMI-M11AA-4-10-B-2	-	4	10	0.52	47	3000	1500	0.25/0.5	001	B

Electrical Schematic

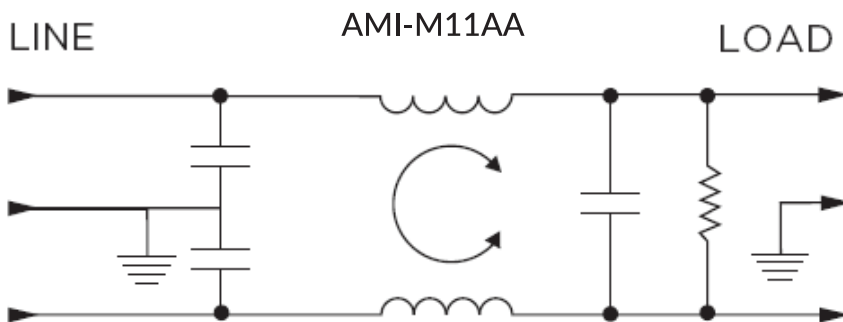

Accessory Outlet Filter

Specifications:

- Rated Voltage (max): 250 VAC
- Operating Frequency: 50/60 Hz
- Operating Current: 1 to 10 A
- Hi-pot Rating (one minute): Line to Ground: 2250 VDC
Line to Line: 1450 VDC
- Operating Ambient Temperature Range (at rated current I_r): -10°C to +40°C. In an ambient temperature (T_a) higher than +40°C the maximum operating current (I_o) is calculated as follows: $I_o = I_r \sqrt{[(85 - T_a) / 45]}$

Performance Data

Typical Insertion Loss

Measured in closed 50 Ohm system

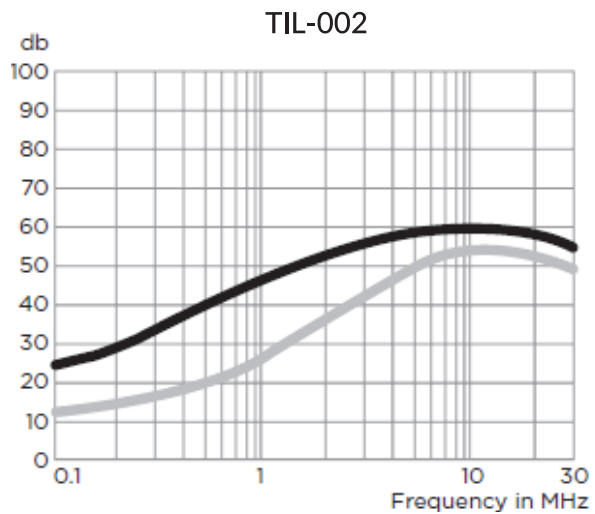
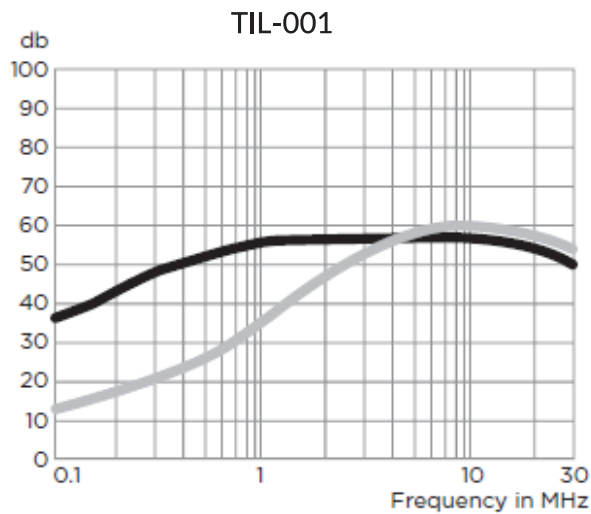

Accessory Outlet Filter

Performance Data

Typical Insertion Loss

Measured in closed 50 Ohm system

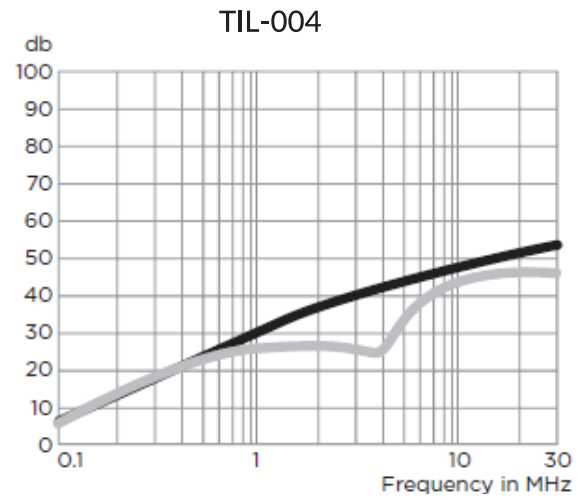
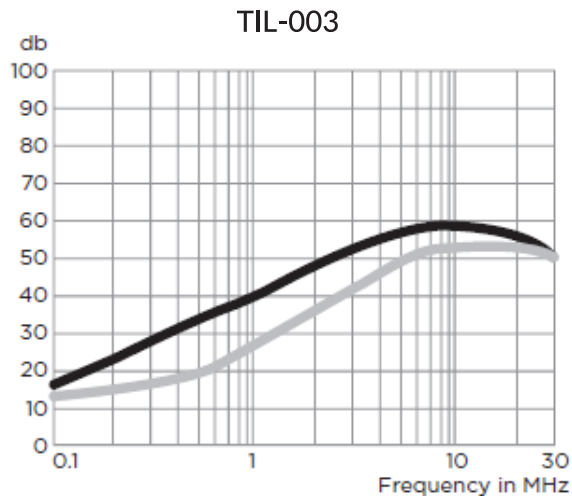

— Common Mode / Asymmetrical (L-G)
 — Differential Mode / Symmetrical (L-L)

Minimum Insertion Loss

Measured in closed 50 Ohm system

Common Mode/Asymmetrical (Line to Ground)

Current Rating	Frequency-MHz						
	.05	.15	.5	1	5	10	30
AMI-M11AA-X-1-B (X=1 4)	23	32	41	47	47	47	40
AMI-M11AA-X-3-B (X=1 4)	10	19	30	36	48	50	47
AMI-M11AA-X-6-B (X=1 4)	1	10	22	28	42	48	47
AMI-M11AA-X-10-B (X=1 4)	1	5	14	20	32	38	47

Accessory Outlet Filter

Minimum Insertion Loss

Differential Mode/Symmetrical (Line to Line)

Current Rating	Frequency-MHz						
	.05	.15	.5	1	5	10	30
AMI-M11AA-X-1-B (X=1 4)	3	14	23	41	47	50	44
AMI-M11AA-X-3-B (X=1 4)	2	11	14	25	38	44	40
AMI-M11AA-X-6-B (X=1 4)	2	10	14	20	33	42	40
AMI-M11AA-X-10-B (X=1 4)	2	10	16	19	19	39	40

Case Styles

STYLE A

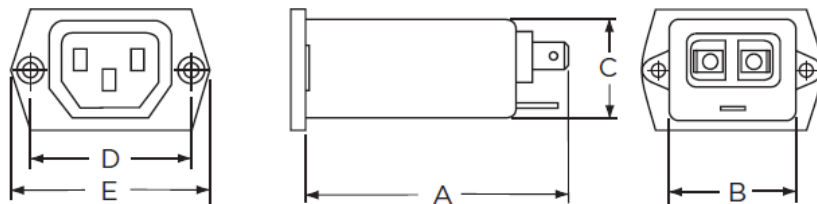

Typical Dimensions:

Mounting holes (2):	.132 [3.35] Dia. with .236 [5.99] Dia. x 90° countersink for #4 flathead screw
Load Outlet (1):	IEC 60320-1 C13
Line Terminals (2):	.250 [6.3] with .07 [1.8] Dia. hole
Ground Terminal (1):	.250 [6.3] with .07 x .16 [1.8 x 3.8] slot

Accessory Outlet Filter

Case Styles

STYLE B

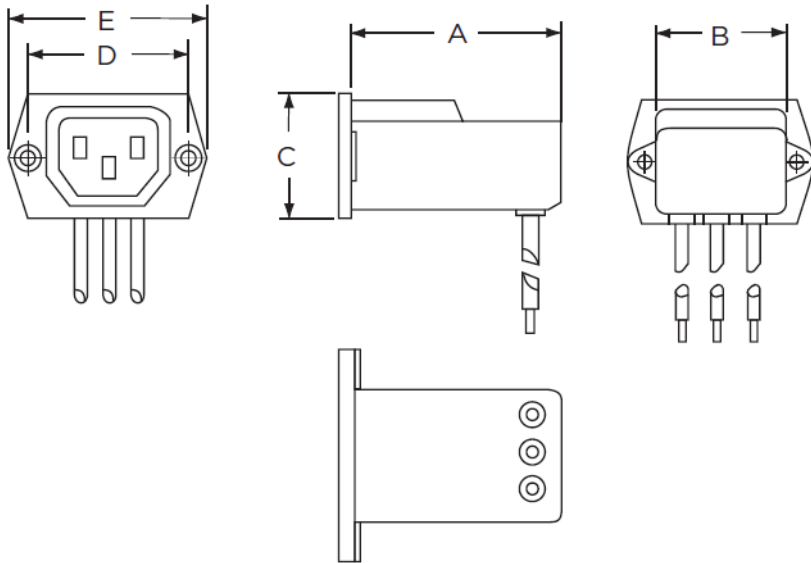

Typical Dimensions:

Mounting holes (2):	.132 [3.35] Dia. with .236 [5.99] Dia. x 90° countersink for #4 flathead screw
Load Outlet (1):	IEC 60320-1 C13
Wire Leads (3):	10.0 [254.0] min., 18AWG, UL1015

Recommended Panel Cutouts

1-15A

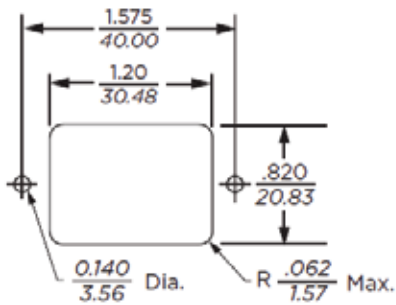

20A

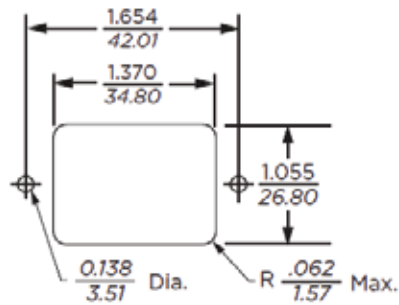

Front Mount Only
Tolerance ±.005 (.13)

Accessory Outlet Filter

Case Dimensions:

Model Number	A max	B max	C max	D $\begin{smallmatrix} \pm .015 \\ \pm .38 \end{smallmatrix}$	E max
AMI-M11AA-1-X-B	2.57"/65.3mm	1.33"/33.8mm	1.00"/25.4mm	1.575"/40.01mm	1.99"/50.5mm
AMI-M11AA-4-X-B	2.09"/53.01mm	1.39"/35.31mm	1.16"/29.46mm	1.575"/40.01mm	1.99"/50.5mm